

2020-2021 LEARNING RECOVERY

Grade 1 Diagnostic and Scope & Sequence

G1M1

G1M2

G1M3

G1M4

G1M5

G1M6

A revised scope and sequence for 1st grade that integrates critical learning from Kindergarten with grade-level work, includes an upfront diagnostic assessment mission and adheres to the following principles:

- **Student-first**, re-engage students in a learning community and provide space for teachers to focus on student’s social and emotional well-being.
- **Practical and actionable**, provide teachers with a comprehensive, usable plan that can be adapted to various forms of hybrid-learning.
- **Efficient and coherent**, ensure students continue to understand math concepts in an intuitive and tangible way.

Zearn Math helps teachers and administrators support students with accessing the revised 1st grade scope and sequence by providing comprehensive materials, guidance and visibility.

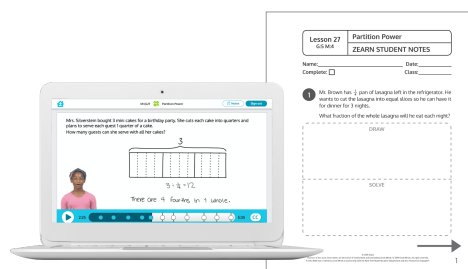

Digital Lessons include built-in deep support on concepts from previous topics and grades

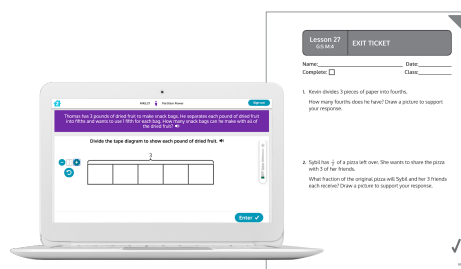

Upfront diagnostic assessment mission and ongoing formative assessments

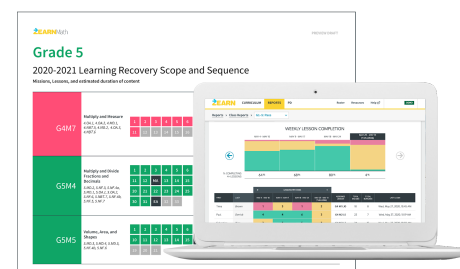

Real-time reports and guidance to precisely track and identify student learning and struggle

Grade 1

2020-2021 Learning Recovery Scope and Sequence

Missions, Lessons, and estimated duration of content

Each Zearn Math digital lesson includes built-in, deep support on concepts from previous topics and grades, which allows for a coherent, manageable and efficient learning experience for all students. Zearn Math digital lessons diagnose unfinished learnings while supporting students to master grade-level content.

Mission Title	Lessons	Assessment	Total Lessons	Instruction Days										
G1M1 Add and Subtract Small Numbers <i>1.OA.1, 1.OA.5, 1.OA.6, 1.OA.8, 1.OA.3, 1.OA.7</i>	1	2	3	4	5	6	7	8	9	10	2 Assessments	32	34	
	11	12	X	14	15	16	17	X	19	20				
	21	22	MA	X	X	25	X	27	X	29				
	30	31	32	33	34	X	36	37	38	39				
	EA													
	<p>Diagnostic Mission: Based on student performance in the diagnostic mission, teachers can visit our <i>Foundational Lesson Guidance for additional student support</i>.</p> <p>The review work on counting, composing and decomposing numbers to 10 in this mission will serve as an upfront diagnostic assessment to inform teacher-led instruction, support students with establishing a sense of belonging in the classroom as they access grade-level work, and help identify individual students who may need additional support.</p> <p>Curriculum Study PD: Prior to teaching this module, complete the full G1M1 Curriculum Study Session — Overview, Fluency, Word Problem, Small Group Lessons (~60 minutes)</p>													

G1M2

Meet Place Value

1.OA.1, 1.OA.3, 1.OA.4,
1.OA.6, 1.OA.5, 1.OA.7,
1.OA.8, 1.NBT.2a,
1.NBT.2b, 1.NBT.5

1	2	3	4	X	6	7	8	X	10
MA	X	12	13	14	15	16	17	18	X
20	X	22	23	X	25	26	27	28	29
EA									

2 Assessments

23

25

Students tackle larger numbers by moving from counting on to more sophisticated decomposition and composition strategies and identifying a 10 as one unit.

Curriculum Study PD: Prior to teaching this module, complete the full G1M2 Curriculum Study Session — Overview, Fluency, Word Problem, Small Group Lessons (~60 minutes)

G1M3

Measure Length

1.MD.1, 1.MD.2, 1.OA.1,
1.MD.4

1	2	X	4	5	6	7	X	9	10
11	X	13	EA						

1 Assessment

10

11

Students learn to develop their reasoning skills, always with concrete objects, by indirectly comparing, classifying and ordering.

Curriculum Study PD: Prior to teaching this module, complete the full G1M3 Curriculum Study Session — Overview, Fluency, Word Problem, Small Group Lessons (~60 minutes)

G1M4

Add and Subtract Bigger Numbers

1.NBT.1, 1.NBT.2,
1.NBT.5, 1.NBT.3,
1.NBT.4, 1.NBT.6, 1.OA.1

1	2	3	4	5	6	X	8	X	10
11	MA	X	13	X	15	16	17	X	19
20	21	X	23	24	25	26	27	28	29
EA									

2 Assessments

23

25

Students extend their understanding of counting on, decomposing and counting strategies to learn new strategies to identify tens and ones, and they'll compare, add, and subtract numbers up to 40.

Curriculum Study PD: Prior to teaching this module, complete the full G1M4 Curriculum Study Session — Overview, Fluency, Word Problem, Small Group Lessons (~60 minutes)

G1M5

Work with Shapes

1.G.1, 1.G.2, 1.G.3, 1.MD.3

1	2	3	4	5	6	7	8	9	10
11	12	13	EA						

1 Assessment

13

14

Students deepen their understanding of part-whole relationships by exploring the part-whole relationship through shapes.

Curriculum Study PD: Prior to teaching this module, complete the full G1M5 Curriculum Study Session — Overview, Fluency, Word Problem, Small Group Lessons (~60 minutes)

G1M6

Add and Subtract to 100

1.OA.1, 1.NBT.1,
1.NBT.2a, 1.NBT.2c,
1.NBT.5, 1.NBT.4

1	2	X	4	5	X	X	X	9	X
11	12	13	14	15	16	X	18	19	MA
20	21	X	X	X	25	26	27	EA	X
X	X								

2 Assessments

18

20

Students learn addition, subtraction, comparing, and place value with numbers up to 100.

Curriculum Study PD: Prior to teaching this module, complete the full G1M6 Curriculum Study Session — Overview, Fluency, Word Problem, Small Group Lessons (~60 minutes)

Total

10
Assessments

119
Lessons

129
Instruction Days



Grade 1 lesson: daily fluency, guided practice and assessment



Excluded lessons for the 2020-21 school year (can be completed outside of core math instruction)

X

Omitted curriculum lesson



MA

Mid-Mission Assessment



EA

End-of-Mission Assessment